

Appendix 1



TOWER HAMLETS

Licence / Registration

Certificate Number

13027

(Denni's News)
15 Swaton Road
London
E3 4ES

Licensable Activities authorised by the licence

The sale by retail of alcohol

See the attached licence for the licence conditions

Signed by

John Cruse 
Team Leader Licensing

JS

Date: 3rd February 2009



Part A - Format of premises licence

Premises licence number

13027

Part 1 - Premises details

Postal address of premises, or if none, ordnance survey map reference or description

(Denni's News)
15 Swaton Road

Post town
London

Post code
E3 4ES

Telephone number
[REDACTED]

Where the licence is time limited the dates

N/A

Licensable activities authorised by the licence

The sale by retail of alcohol

The times the licence authorises the carrying out of licensable activities

The sale by retail of alcohol

- Monday to Sunday, from 09:00 hours to 23:00 hours

The opening hours of the premises

- Monday to Sunday, from 07:00 hours to 23:00 hours

Where the licence authorises supplies of alcohol whether these are on and/ or off supplies

Off sales only

Part 2

Name, (registered) address, telephone number and email (where relevant) of holder of premises licence



Registered number of holder, for example company number, charity number (where applicable)

N/A

Name, address and telephone number of designated premises supervisor where the premises licence authorises the supply of alcohol



Personal licence number and issuing authority of personal licence held by designated premises supervisor where the premises licence authorises for the supply of alcohol

Personal Licence Number: 

Issuing Authority: 

Annex 1 - Mandatory conditions

No supply of alcohol may be made under the premises licence-

- a) at a time where there is no designated premises supervisor in respect of the premises licence, or
- b) at a time when the designated premises supervisor does not hold a personal licence or his personal licence is suspended

Every supply of alcohol under the premises licence must be made or authorised by a person who holds a personal licence

Annex 2 - Conditions consistent with the operating Schedule

1. No nudity or semi nudity permitted.
2. All deliveries and the collection of refuse will take place during the day time hours.
3. Staff shall ask any persons who appear to be under the age of 18 for PASS approved Identifications, passport or photo driving licences.
4. No employee under the age of 18 years of age will be responsible for the sale of intoxicating liquor.

Annex 3 - Conditions attached after a hearing by the licensing authority

1. CCTV shall be operated and maintained as the requirements of the Metropolitan Police. The CCTV recordings shall be kept for a minimum period of 31 days and made available to an Authorised Officer or a Police Officer on request.
2. A refusals book and incidents book to be kept and maintained.

Annex 4 - Plans

The plans are those submitted to the licensing authority on the following date:

29 August 2008



TOWER HAMLETS

Licensing Act 2003

Part B - Premises licence summary

Premises licence number

13027

Premises details

Postal address of premises, or if none, ordnance survey map reference or description

(Denni's News)
15 Swaton Road

Post town
London

Post code
E3 4ES

Telephone number
020 7987 1750

Where the licence is time limited the dates

N/A

Licensable activities authorised by the licence

The sale by retail of alcohol

The times the licence authorises the carrying out of licensable activities

The sale by retail of alcohol

- Monday to Sunday, from 09:00 hours to 23:00 hours

The opening hours of the premises

- Monday to Sunday, from 07:00 hours to 23:00 hours

Name, (registered) address of holder of premises licence

[Redacted]

Where the licence authorises supplies of alcohol whether these are on and / or off supplies

Off sales only

Registered number of holder, for example company number, charity number (where applicable)

N/A

Name of designated premises supervisor where the premises licence authorises for the supply of alcohol

Mr Dinesh Kanzaria

State whether access to the premises by children is restricted or prohibited

No restrictions

Appendix 2

DENNI'S NEWS, 15, Swaton Road, London E3 4ES

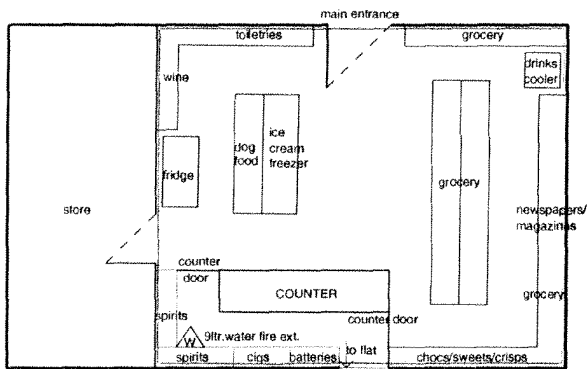

Dorset Licensing
Prepared for :- Mr.D. Kanzaria
Application for grant of a Premises Licence
Scale 1:100 Ref. AD42/805120/P1/21/08/2008

0 1m 2m 3m 4m 5m

Appendix 3

[Insert name and address of relevant licensing authority and its reference number (optional)]

Application to vary a premises licence under the Licensing Act 2003

PLEASE READ THE FOLLOWING INSTRUCTIONS FIRST

Before completing this form please read the guidance notes at the end of the form.
If you are completing this form by hand please write legibly in block capitals. In all cases ensure that your answers are inside the boxes and written in black ink. Use additional sheets if necessary.
You may wish to keep a copy of the completed form for your records.

I/We Dinesh Kanzaria being the premises licence holder, apply to vary a
(insert name(s) of applicant)
premises licence under section 34 of the Licensing Act 2003 for the premises
described in Part 1 below

Premises licence number

13027

Part 1 – Premises details

Postal address of premises or, if none, ordnance survey map reference, or description	
Denni's News, 15 Swaton Road, London,	
Post town	Post code
London	E3 4ES

Telephone number at premises (if any)

[REDACTED]

Non-domestic rateable value of premises

£ 4,400

Part 2 – Applicant details

Daytime contact telephone number

[REDACTED]

E-mail address
(optional)

[REDACTED]

Current postal
address if
different from
premises address

[REDACTED]

Post Town

[REDACTED]

Postcode

[REDACTED]

LD 11
TRAINING STANDARDS
25 JUL 2010
[Signature]

Part 3 - Variation

Do you want the proposed variation to have effect as soon as possible? Please tick Yyes

If not do you want the variation to take effect from

Day	Month	Year					
-----	-------	------	--	--	--	--	--

If your proposed variation would mean that 5,000 or more people are expected to attend the premises at any one time, please state the number expected to attend

Please describe briefly the nature of the proposed variation (Please see guidance note 1)

To add a three meter extension to the front of the premises and include the existing store room within the existing licensed area

Part 4 Operating Schedule

Please complete those parts of the Operating Schedule below which would be subject to change if this application to vary is successful.

Please tick yes

Provision of regulated entertainment

- a) plays (if ticking yes, fill in box A)
- b) films (if ticking yes, fill in box B)
- c) indoor sporting events (if ticking yes, fill in box C)
- d) boxing or wrestling entertainment (if ticking yes, fill in box D)
- e) live music (if ticking yes, fill in box E)
- f) recorded music (if ticking yes, fill in box F)
- g) performances of dance (if ticking yes, fill in box G)
- h) anything of a similar description to that falling within (e), (f) or (g)
(if ticking yes, fill in box H)

Provision of entertainment facilities for:

- i) making music (if ticking yes, fill in box I)
- j) dancing (if ticking yes, fill in box J)
- k) entertainment of a similar description to that falling within (i) or (j)
(if ticking yes, fill in box K)

Provision of late night refreshment (if ticking yes, fill in box L)

Sale by retail of alcohol (if ticking yes, fill in box M)

In all cases complete boxes N, O and P

A

Plays Standard days and timings (please read guidance note 6)			Will the performance of a play take place indoors or outdoors or both – please tick [Y] (please read guidance note 2)	Indoors	
Day	Start	Finish		Outdoors	
Mon			Please give further details here (please read guidance note 3)	Both	
Tue					
Wed					
Thur			State any seasonal variations for performing plays (please read guidance note 4)		
Fri					
Sat			Non standard timings. Where you intend to use the premises for the performance of plays at different times to those listed in the column on the left, please list (please read guidance note 5)		
Sun					

B

Films Standard days and timings (please read guidance note 6)			Will the exhibition of films take place indoors or outdoors or both – please tick [Y] (please read guidance note 2)	Indoors	
Day	Start	Finish		Outdoors	
Mon			Please give further details here (please read guidance note 3)	Both	
Tue					
Wed					
Thur			State any seasonal variations for the exhibition of films (please read guidance note 4)		
Fri					
Sat			Non standard timings. Where you intend to use the premises for the exhibition of films at different times to those listed in the column on the left, please list (please read guidance note 5)		
Sun					

C

Indoor sporting events Standard days and timings (please read guidance note 6)			Please give further details (please read guidance note 3)
Day	Start	Finish	
Mon			State any seasonal variations for indoor sporting events (please read guidance note 4)
Tue			
Wed			
Thur			Non standard timings. Where you intend to use the premises for indoor sporting events at different times to those listed in the column on the left, please list (please read guidance note 5)
Fri			
Sat			
Sun			

D

Boxing or wrestling entertainments Standard days and timings (please read guidance note 6)			Will the boxing or wrestling entertainment take place indoors or outdoors or both – please tick [Y] (please read guidance note 2)	Indoors	
Day	Start	Finish		Outdoors	
Mon			Please give further details here (please read guidance note 3)	Both	
Tue					
Wed					
Thur			State any seasonal variations for boxing or wrestling entertainment (please read guidance note 4)		
Fri					
Sat					
			Non standard timings. Where you intend to use the premises for boxing or wrestling entertainment at different times to those listed in the column on the left, please list (please read guidance note 5)		

Sun			
-----	--	--	--

E

Live music Standard days and timings (please read guidance note 6)			Will the performance of live music take place indoors or outdoors or both – please tick [Y] (please read guidance note 2)	Indoors			
Day	Start	Finish		Outdoors			
Mon			Please give further details here (please read guidance note 3)	Both			
Tue							
Wed				State any seasonal variations for the performance of live music (please read guidance note 4)			
Thur							
Fri					Non standard timings. Where you intend to use the premises for the performance of live music at different times to those listed in the column on the left, please list (please read guidance note 5)		
Sat							
Sun							

F

Recorded music Standard days and timings (please read guidance note 6)			Will the playing of recorded music take place indoors or outdoors or both – please tick [Y] (please read guidance note 2)	Indoors		
Day	Start	Finish		Outdoors		
Mon			Please give further details here (please read guidance note 3)	Both		
Tue						
Wed				State any seasonal variations for playing recorded music (please read guidance note 4)		
Thur						

Fri			Non standard timings. Where you intend to use the premises for the playing of recorded music entertainment at different times to those listed in the column on the left, please list (please read guidance note 5)
Sat			
Sun			

G

Performances of dance Standard days and timings (please read guidance note 6)			Will the performance of dance take place indoors or outdoors or both – please tick [Y] (please read guidance note 2)	Indoors	
Day	Start	Finish		Outdoors	
Mon			Please give further details here (please read guidance note 3)	Both	
Tue					
Wed			State any seasonal variations for the performance of dance (please read guidance note 4)		
Thur					
Fri			Non standard timings. Where you intend to use the premises for the performance of dance entertainment at different times to those listed in the column on the left, please list (please read guidance note 5)		
Sat					
Sun					

H

Anything of a similar description to that falling within (e), (f) or (g) Standard days and timings (please read guidance note 6)			Please give a description of the type of entertainment you will be providing	Indoor	
Day	Start	Finish		Outdoor	
Mon			Will this entertainment take place indoors or outdoors or both – please tick [Y] (please read guidance note 2)	Both	

Tue			Please give further details here (please read guidance note 3)
Wed			
Thur			
Fri			State any seasonal variations for entertainment of a similar description to that falling within (e), (f) or (g) (please read guidance note 4)
Sat			
Sun			Non standard timings. Where you intend to use the premises for the entertainment of similar description to that falling within (e), (f) or (g) at different times to those listed in the column on the left, please list (please read guidance note 5)

Provision of facilities for making music Standard days and timings (please read guidance note 6)			Please give a description of the facilities for making music you will be providing		
			Will the facilities for making music be indoors or outdoors or both – please tick [Y] (please read guidance note 2)		
Day	Start	Finish	Indoors		
			Outdoors		
			Both		
Mon			Please give further details here (please read guidance note 3)		
Tue					
Wed			State any seasonal variations for the provision of facilities for making music (please read guidance note 4)		
Thur					
Fri			Non standard timings. Where you intend to use the premises for provision of facilities for making music entertainment at different times to those listed in the column on the left, please list (please read guidance note 5)		
Sat					
Sun					

J

Provision of facilities for dancing Standard days and timings (please read guidance note 6)			Will the facilities for dancing be indoors or outdoors or both – please tick [Y] (see guidance note 2)	Indoors	
				Outdoors	
				Both	
Day	Start	Finish	Please give a description of the facilities for dancing you will be providing		
Mon			Please give further details here (please read guidance note 3)		
Tue					
Wed			State any seasonal variations for providing dancing facilities (please read guidance note 4)		
Thur					
Fri			Non standard timings. Where you intend to use the premises for the provision of facilities for dancing entertainment at different times to those listed in the column on the left, please list (please read guidance note 5)		
Sat					
Sun					

K

Provision of facilities for entertainment of a similar description to that falling within I or J Standard days and timings (please read guidance note 6)			Please give a description of the type of entertainment facility you will be providing		
Day	Start	Finish	Will the entertainment facility be indoors or outdoors or both – please tick [Y] (please read guidance note 2)	Indoor	
				Outdoor	
Mon				Both	

Tue			Please give further details here (please read guidance note 3)
Wed			
Thur			State any seasonal variations for the provision of facilities for entertainment of a similar description to that falling within I or J (please read guidance note 4)
Fri			
Sat			Non standard timings. Where you intend to use the premises for the provision of facilities for entertainment of a similar description to that falling within I or J at different times to those listed in the column on the left, please list (please read guidance note 5)
Sun			

L

Late night refreshment Standard days and timings (please read guidance note 6)			Will the provision of late night refreshment take place indoors or outdoors or both – please tick [Y] (please read guidance note 2)	Indoors	
Day	Start	Finish		Outdoors	
Mon			Please give further details here (please read guidance note 3)	Both	
Tue					
Wed			State any seasonal variations for the provision of late night refreshment (please read guidance note 4)		
Thur					
Fri			Non standard timings. Where you intend to use the premises for the provision of late night refreshment at different times, to those listed in the column on the left, please list (please read guidance note 5)		
Sat					
Sun					

M

Supply of alcohol Standard days and timings (please read guidance note 6)			Will the sale of alcohol be for consumption (Please tick box Y) (please read guidance note 7)	On the premises	
				Off the premises	
Both					
Day	Start	Finish	State any seasonal variations for the supply of alcohol (please read guidance note 4)		
Mon					
Tue					
Wed					
Thur					
Fri					
Sat					
Sun			Non-standard timings. Where you intend to use the premises for the supply of alcohol at different times to those listed in the column on the left, please list (please read guidance note 5)		

N

Please highlight any adult entertainment or services, activities, other entertainment or matters ancillary to the use of the premises that may give rise to concern in respect of children (please read guidance note 8)

There are no services, activities, other entertainment or matters ancillary to the use of the premises that may give rise to concern in respect of children.

O

Hours premises are open to the public Standard days and timings (please read guidance note 6)			State any seasonal variations (please read guidance note 4)
Day	Start	Finish	
Mon			
Tue			

Wed			Non standard timings. Where you intend to use the premises to be open to the public at different times from those listed in the column on the left, please list (please read guidance note 5)
Thur			
Fri			
Sat			
Sun			

Please identify those conditions currently imposed on the licence which you believe could be removed as a consequence of the proposed variation you are seeking

To extend the the existing licensed area

- I have enclosed the premises licence Please tick ✓ yes
- I have enclosed the relevant part of the premises licence If you have not ticked one of these boxes please fill in reasons for not including the licence, or part of it, below

Reasons why I have failed to enclose the premises licence or relevant part of premises licence

P

Describe any additional steps you intend to take to promote the four licensing objectives as a result of the proposed variation:

a) General – all four licensing objectives (b,c,d,e) (please read guidance note 9)

This application is to extend the existing licensed area

b) The prevention of crime and disorder

NO CHANGE

c) Public safety

NO CHANGE

d) The prevention of public nuisance

NO CHANGE

e) The protection of children from harm

NO CHANGE

Please tick ✓ yes

- I have made or enclosed payment of the fee
- I have sent copies of this application and the plan to responsible authorities and others where applicable
- I understand that I must now advertise my application
- I have enclosed the premises licence or relevant part of it or explanation
- I understand that if I do not comply with the above requirements my application will be rejected

IT IS AN OFFENCE, LIABLE ON CONVICTION TO A FINE UP TO LEVEL 5 ON THE STANDARD SCALE, UNDER SECTION 158 OF THE LICENSING ACT 2003 TO MAKE A FALSE STATEMENT IN OR IN CONNECTION WITH THIS APPLICATION

Part 5 – Signatures (please read guidance note 10)

Signature of applicant (the current premises licence holder) or applicant's solicitor or other duly authorised agent (please read guidance note 11). If signing on behalf of the applicant please state in what capacity.

Signature

[Redacted Signature]

Date.....23rd July, 2010.....

Capacity Dorset Licensing - authorised agents for applicants.

Where the premises licence is jointly held signature of 2nd applicant (the current premises licence holder) or 2nd applicant's solicitor or other authorised agent (please read guidance note 12). If signing on behalf of the applicant please state in what capacity.

Signature

N/A

Date.....23rd July, 2010.....

Capacity Dorset Licensing - authorised agents for applicants.

Contact name (where not previously given) and address for correspondence associated with this application (please read guidance note 13)	
[Redacted Contact Name and Address]	
Post town Poole	Post code [Redacted Post Code]
Telephone number (if any) [Redacted Telephone Number]	
If you would prefer us to correspond with you by e-mail your e-mail address (optional) [Redacted E-mail Address]	

Appendix 4

DENNI'S NEWS, 15, Swaton Road, London E3 4ES

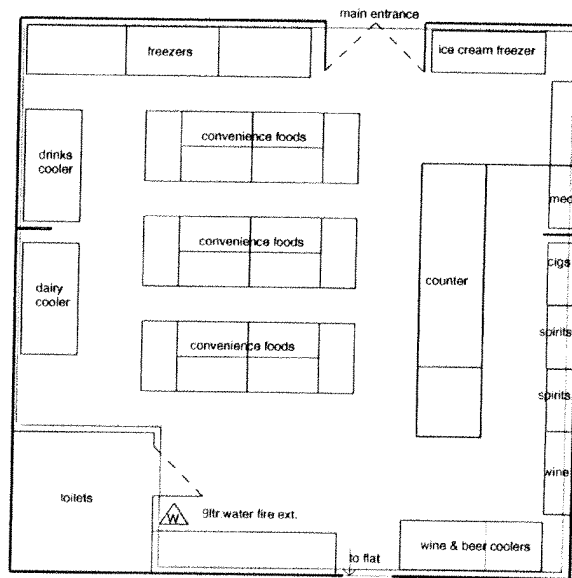

Dorset Licensing

Prepared for :- Mr.D. Kanzaria

Application for variation of a Premises Licence

Scale 1:100 Ref. AD42/805120/P4/14072010

0 1m 2m 3m 4m 5m

Appendix 5

Map



Scale 1:500

Map of:

15 Swaton Rd

Notes:

Produced 7 September 2010 from Ordnance Survey digital data and incorporating surveyed revision available at this date.
© Crown Copyright 1998.

Reproduction in whole or part is prohibited without prior permission of Ordnance Survey

Supplied by London Borough of Tower Hamlets

Licence Number: LA100019288

Map

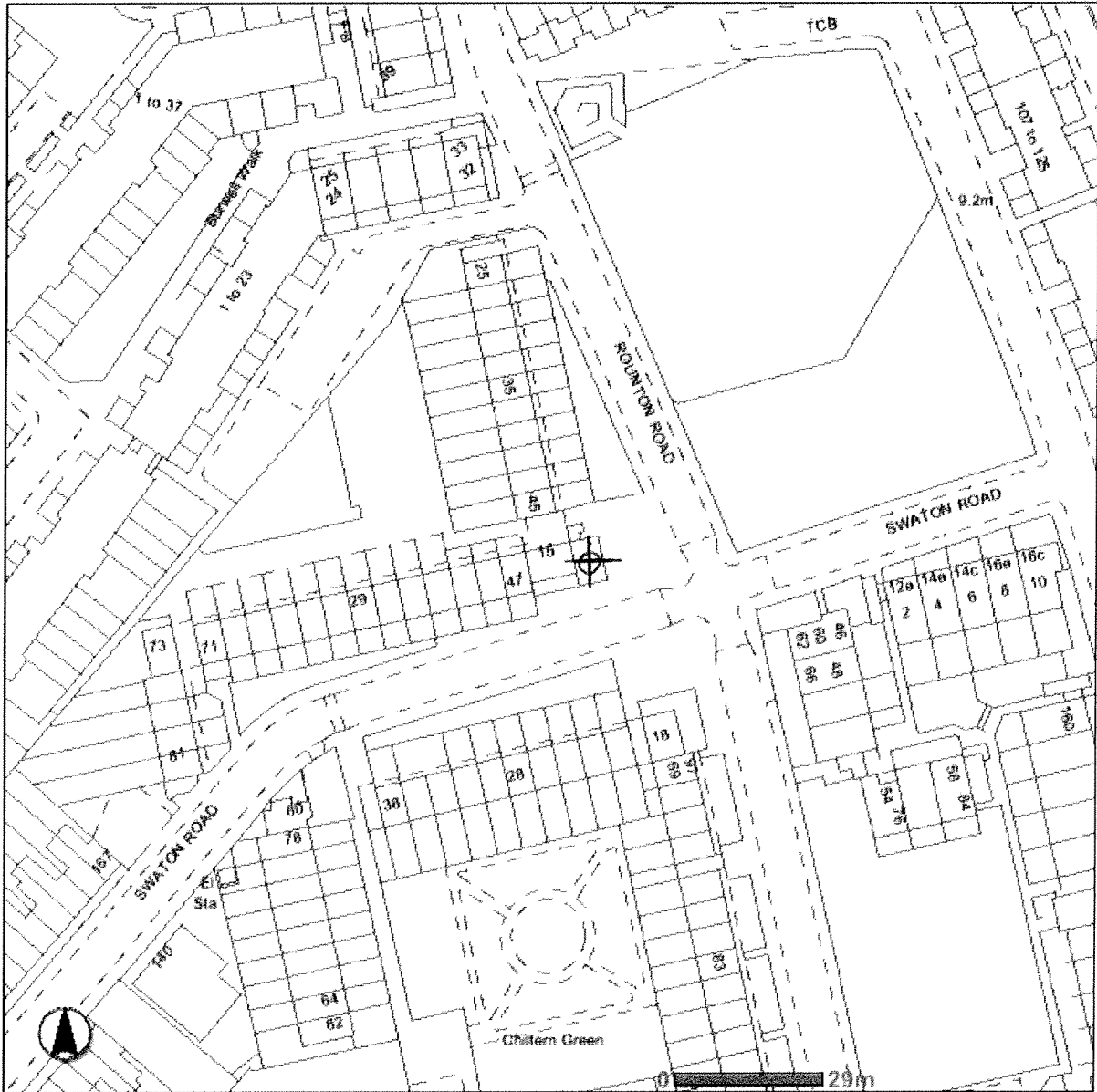

Scale 1:1250

Map of:

15 Swaton Rd

Notes:

Produced 7 September 2010 from Ordnance Survey digital data and incorporating surveyed revision available at this date.
© Crown Copyright 1998.

Reproduction in whole or part is prohibited without prior permission of Ordnance Survey

Supplied by London Borough of Tower Hamlets

Licence Number: LA100019288

Map



Scale 1:2500

Map of:

15 Swaton Rd

Notes:

Produced 7 September 2010 from Ordnance Survey digital data and incorporating surveyed revision available at this date.
© Crown Copyright 1998.

Reproduction in whole or part is prohibited without prior permission of Ordnance Survey

Supplied by London Borough of Tower Hamlets

Licence Number: LA100019288

Appendix 6

Section 182 Advice by the DCMS

RELEVANT, VEXATIOUS AND FRIVOLOUS REPRESENTATIONS

- 9.8 A representation would only be “relevant” if it relates to the likely effect of the grant of the licence on the promotion of at least one of the licensing objectives. For example, a representation from a local businessman which argued that his business would be commercially damaged by a new licensed premises would not be relevant. On the other hand, a representation that nuisance caused by the new premises would deter customers from entering the local area and the steps proposed by the applicant to control that nuisance were inadequate would be relevant. There is no requirement for an interested party or responsible authority to produce a recorded history of problems at a premises to support their representations, and in fact this would not be possible for new premises. Further information for interested parties about the process for making representations is available in “Guidance for interested parties: Making representations” which can be found on the DCMS website.
- 9.9 The “cumulative impact” on the licensing objectives of a concentration of multiple licensed premises may also give rise to a relevant representation when an application for the grant or variation of a premises licence is being considered, but not in relation to an application for review which must relate to an individual premises.
- 9.10 It is for the licensing authority to determine whether any representation by an interested party is frivolous or vexatious on the basis of what might ordinarily be considered to be vexatious or frivolous. Vexation may arise because of disputes between rival businesses and local knowledge will therefore be invaluable in considering such matters. Frivolous representations would be essentially categorised by a lack of seriousness. An interested party who is aggrieved by a rejection of their representations on these grounds may challenge the authority’s decision by way of judicial review.

- 9.11 Licensing authorities should not take decisions on whether representations are relevant on the basis of any political judgement. This may be difficult for ward councillors receiving complaints from residents within their own wards. If consideration is not to be delegated, contrary to the recommendation in this Guidance, an assessment should be prepared by officials for consideration by the subcommittee before any decision is taken that necessitates a hearing. Any ward councillor who considers that their own interests are such that they are unable to consider the matter independently should disqualify themselves.
- 9.12 The Secretary of State recommends that in borderline cases, the benefit of the doubt should be given to the interested party making the representation. The subsequent hearing would then provide an opportunity for the person or body making the representation to amplify and clarify it. If it then emerged, for example, that the representation should not be supported, the licensing authority could decide not to take any action in respect of the application.
- 9.13 Licensing authorities should consider providing advice on their websites about how any interested party can make representations to them.

Appendix 7

Isfa Uddin

Tower Hamlets
Licensing Dept
Mulberry Place(AH)
PO Box55739
5 Clove Crescent
London
E14 1BY

Date 19/10/2010

Dear sir/ Madam

Re: Extension to Denni' News 15 Swaton Road London E3 4ES.

I am opposing to the Three meter extension and the proposed time extension TSS/LIC/042523

I am a local resident, and I live in 57 Swaton road. Denni's News agent is about 50 yards away from my front door, this is situated by the entrance of my flat. The proposed extension will be directly close to our entrance to the flat, this will create a narrow passage leading to our flat. The narrow passage will create a safe haven for the drunken people to hang around. It will effect me and my family from entering and leaving the flat at all times.

Denni's news is situated in a residential area next to the flats. Un fortunately this is ~~where we call home,~~ where we live with our family. Despite hundreds of people opposing against this off licence, the authority have still been granted the licence. Now he wants to extend the shop making our entrance narrower, above this he will also be selling alcohol which will cause problems in this part of the area. This will cause more trouble to an already troublesome area. There is often knife stabbings, one person has been killed, gun shots have been heard more than twice, a gun was found under a car, un controlled drug abuse. Recently police had to create a dispersal zone to control the situation. We do not want any more crime in this area there fore I am opposing against the extension. I hope you will be taking our concerns in to account and will consider this case.

Thank you
Your sincerely

Isfa Uddin

LBTH
TRADING STANDARDS
20 AUG 2010
LICENSING

To the Licensing Authority LBTH

Dennis News 15 Swaton Road
Re TSS/LIC/042523

Objection to Extension to the front of the shop and the opening time extension to the above mentioned shop (Dennis News)

- 1 Narrowing our entrance to Building
- 2 May Increase gathering of drunken youths in the already trouble some area
- 3 May hassling residents in or out of the flats

Name	Address	Signature	Date
LIBIA ALI	[REDACTED]	[REDACTED]	20 8 10
AKDOR ALI	[REDACTED]	[REDACTED]	20-8-10
IBDOL KODDOS	[REDACTED]	[REDACTED]	20 08
SHUHAILAH ALI	[REDACTED]	[REDACTED]	20/08/10
PICAK BEON	[REDACTED]	[REDACTED]	20/8/10
JANARA BEGUM	[REDACTED]	[REDACTED]	20/08/2010
HALIMA KHANAM	[REDACTED]	[REDACTED]	20/08/2010
WILFIRAH KHANAM	[REDACTED]	[REDACTED]	20/08/10
MIZANUR RAHMAN	[REDACTED]	[REDACTED]	20/08/10
TAKIYU KHANAM	[REDACTED]	[REDACTED]	20 08 10
N HUSSAIN	[REDACTED]	[REDACTED]	20-08-10
ANSAR UDDIN	[REDACTED]	[REDACTED]	20 08 10
ASAD AHMED	[REDACTED]	[REDACTED]	20-08-10
SAMUEL ALI	[REDACTED]	[REDACTED]	20 8 10
SAMUEL ALI	[REDACTED]	[REDACTED]	20-8-10
HUSNAN ALI	[REDACTED]	[REDACTED]	20-8-10
RAKTHEK	[REDACTED]	[REDACTED]	20-8-10
K BEGUM	[REDACTED]	[REDACTED]	20 8 10

20 AUG 2010
LICENSING

Appendix 8

<u>List of residents on the petition against the premises</u>				
	Name	Address1	Address2	Postcode
1	Isfa Uddin	Swaton Road	London	E3
2	Liba Ali	Swaton Road	London	E3
3	Akber Ali	Swaton Road	London	E3
4	Abdul Kuddos	Rounton Road	London	E3
5	Shuhelahhed	Swaton Road	London	E3
6	P Begum	Swaton Road	London	E3
7	J Begum	Swaton Road	London	E3
8	Halima Khanom	Swaton Road	London	E3
9	W Rahman	Swaton Road	London	E3
10	Mizanur Rahman	Swaton Road	London	E3
11	The Occupier	Swaton Road	London	E3
12	N Hussain	Swaton Road	London	E3
13	Ansar Uddin	Swaton Road	London	E3
14	Asad Ahmed	Swaton Road	London	E3
15	S Miah	Swaton Road	London	E3
16	R Akther	Swaton Road	London	E3
17	K Begum	Swaton Road	London	E3

Appendix 9

Noise while the premise is in use

General Advice

If they conclude this is a problem Members should consider whether it is possible to carry out suitable and proportionate noise control measures so that noise leakage is prevented. In addition Members may consider that only certain activities are suitable.

The hours of operation also need to be considered (see below).

If Members believe that there is a substantial problem of noise while the premises are in use and it cannot be proportionately address by licensing conditions they should refuse the application.

Licensing Policy

The policy recognises that noise nuisance can be an issue, especially if a premises is open late at night. (**See Sections 8.1 of the Licensing Policy**).

The policy also recognises that staggered closing can help prevent problems at closure time (**See Section 12.1**).

However, while all applications will be considered on their merits, consideration will be given to imposing stricter conditions in respect of noise control where premises are situated close to local residents. (**See Section 12.4**).

The Licensing Authority expects the applicant to have addressed all nuisance issues relating to the premises in their operating schedule and to have sought appropriate advice from the Council's Environmental Health Officers. (**See Sections 8.2 of the Licensing Policy**).

The Licensing Authority will consider attaching conditions to prevent nuisance and these may include Conditions drawn from the Model Poll of Conditions relating to Crime and Disorder. (**See Appendix 2 Annex D of the Licensing Policy**). In particular Members may wish to consider (this list is not exhaustive):

- hours of opening (this needs to be balanced against potential disorder caused by artificially early closing times)
- Whether certain parts should close earlier than the rest (for example a "beer garden", or restricted in their use)
- Whether or not certain activities should have to close at an early hour, for example live music

- Conditions controlling noise or vibration (for example, noise limiters, keeping doors and windows closed).
- Prominent clear and legible notices at all exits requesting the public to respect the needs of local residents and leave the premises and area quietly
- Conditions controlling the use of explosives, pyrotechnics and fireworks
- Conditions controlling the placing of refuse
- Conditions controlling noxious smells
- Conditions controlling lighting (this needs to be balanced against potential crime prevention benefits)

Police Powers

Part 8 of the Licensing Act 2003 enables a senior police officer to close down a premises for up to 24 hrs. a premises causing a nuisance resulting from noise emanating from the premises.

Guidance Issued under Section 182 of the Licensing Act 2003

The Licensing Policy has adopted the recommended Pool of Conditions as permitted (13.20 and Annex D).

The prevention of public nuisance could include low-level nuisance, perhaps affecting a few people living locally as well as major disturbance affecting the whole community (2.33).

Licence conditions should not duplicate other legislation (1.16).

Necessary and appropriate conditions should normally focus on the most sensitive periods (2.36) and may address disturbance as customers enter or leave the premises but it is essential that conditions are focused on measures within the direct control of the licence holder (2.38).

Other Legislation

The Environmental Protection Act 1990, Part 111 gives Environmental Health Officers the power to deal with statutory nuisances.

The Anti-social Behaviour Act 2003, Sections 40 and 41 give Environmental Health Officers the power of closure up to 24 hours in certain circumstances.

Appendix 10

Access and egress problems

Such as:

Disturbance from patrons arriving/leaving the premises on foot

Disturbance from patrons arriving/leaving the premises by car

Lack of adequate car parking facilities

Close proximity to residential properties

Comment

The above have been grouped together as egress problems. Of course the particular facts will be different for each alleged problem.

General Advice

In considering concerns relating to disturbance from egress, Members need to be satisfied that the premises under consideration has been identified as the source of the actual or potential disturbance. If they are satisfied that this is a problem, then proportionate conditions should be considered.

The hours of operation also need to be considered.

If Members believe that there is a substantial problem concerning egress and it cannot be proportionately addressed by licensing conditions, they should refuse the application.

Licensing Policy

The policy recognises that noise nuisance can be an issue, especially if a premises is open late at night. (**See Sections 8.1 of the Licensing Policy**).

The Licensing Authority expects the applicant to have addressed all nuisance issues relating to the premises in their operating schedule and to have sought appropriate advice from the Council's Environmental Health Officers. (**See Sections 8.2 of the Licensing Policy, and also Section 12.5**).

The policy also recognises that staggered closing can help prevent problems at closure time (**See Section 12.1**).

However, while all applications will be considered on their merits, consideration will be given to imposing stricter conditions in respect of noise control where premises are situated close to local residents. (**See Section 12.4**)

The Licensing Authority will consider attaching conditions to prevent nuisance and these may include Conditions drawn from the Model Poll of Conditions relating to the prevention of Public Nuisance. **(See Appendix 2 Annex G of the Licensing Policy)**. In particular Members may wish to consider (this list is not exhaustive):

- hours of opening (this needs to be balanced against potential disorder caused by artificially early closing times)
- Whether certain parts should close earlier than the rest (for example a “beer garden”, or restricted in their use)
- Whether or not certain activities should have to close at an early hour, for example live music
- Conditions controlling noise or vibration (for example, noise limiters, keeping doors and windows closed).
- Prominent clear and legible notices at all exits requesting the public to respect the needs of local residents and leave the premises and area quietly

Guidance Issued under Section 182 of the Licensing Act 2003

The pool of conditions, adopted by the council is recommended (13.20 and Annex D).

The prevention of public nuisance could include low-level nuisance, perhaps affecting a few people living locally as well as major disturbance affecting the whole community. (2.33).

Licence conditions should not duplicate other legislation (1.16).

Necessary and appropriate conditions should normally focus on the most sensitive periods and may address disturbance as customers enter or leave the premises (2.36) but it is essential that conditions are focused on measures within the direct control of the licence holder” (2.38).

In certain circumstances conditions relating to noise in the immediate vicinity of the premises may also prove necessary to address any disturbance anticipated as customers enter and leave (2.36).

However, it is essential that conditions are focused on measures within the direct control of the licence holder. Conditions relating to behaviour once they are beyond the control of the licence holder cannot be justified. (2.38)

Appendix 11

Crime and disorder on the premises

Licensing Policy

The Licensing Authority expects the applicant to have addressed all crime and disorder issues relating to the premises in their operating schedule and to have sought appropriate advice. **(See Sections 5.2. of the Licensing Policy)**

The Licensing Authority will consider attaching conditions to deter crime and disorder and these may include conditions drawn from the Model Pool of Conditions relating to Crime and Disorder. **(See Appendix 2 Annex D of the Licensing Policy)**. In particular Members may wish to consider (this list is not exhaustive):

- Methods of management communication
- Use of registered Door Supervisors
- Bottle Bans
- Plastic containers
- CCTV
- Restrictions on open containers for "off sales"
- Restrictions on drinking areas
- Capacity
- Proof of Age scheme
- Crime prevention notices
- Drinks promotions-aimed at stopping irresponsible promotions
- Signage
- Seating plans
- Capacity

If Members believe that there is a substantial problem of anti-social behaviour and it cannot be proportionately addressed by licensing conditions they should refuse the application.

Police Powers

The Licensing Act 2003, Part 8 gives a senior police officer the power to close a premises for up to 24 hours where the officer believes there is, or is likely to be disorder on or in the vicinity and closure is necessary in the interests of public safety.

Guidance Issued under Section 182 of the Licensing Act 2003.

The pool of conditions, adopted by the council is recommended (Annexe D).

The key role of the police is acknowledged (2.2).

Conditions attached to licences cannot seek to manage the behaviour of customers once they are beyond the direct management of the licence holder and their staff or agents, but can directly impact on the behaviour of customers on, or in the immediate vicinity of the premises as they seek entry or leave (2.4).

Conditions are best targeted on deterrence and preventing crime and disorder (S.2.6) communication, CCTV, police liaison, no glasses, capacity limits are all relevant (S.2.7-2.11).

Guidance Issued under Section 182 of the Licensing Act 2003

Conditions can be imposed for large capacity "vertical consumption" premises (10.43).

Guidance Issued by the Office of Fair Trading

This relates to attempts to control minimum prices

Other Legislation

The Council has a duty under Section 17 of the Crime and Disorder Act 1998 to do all it reasonably can to prevent crime and disorder.

Appendix 12

Crime and disorder from patrons leaving the premises

General Advice

Members need to bear in mind that once patrons have left a premises they are no longer under direct control. Members will need to be satisfied that there is a link between the way the premises is operating and the behaviour that is complained of. An example of this would be that irresponsible drinking is being encouraged. Before deciding that any particular licensing conditions are proportionate, Members will also need to be satisfied that other legislation is not a more effective route. For example, if the problem is drinking in the street it may be that the Council should designate the area as a place where alcohol cannot be consumed in public.

Members may also wish to consider whether the hours of opening relate to any problems of anti-social behaviour.

If Members believe that there is a substantial problem of anti-social behaviour and it cannot be proportionately addressed by licensing conditions they should refuse the application.

Licensing Policy

The policy recognises that other legislation or measures may be more appropriate but also states that licensing laws are “a key aspect of such control and will always be part of an overall approach to the management of the evening and night time economy.” Other controls need to be borne in mind. **(See Section 4.10 and 4.11 of the Licensing Policy).**

- The Licensing Authority will consider attaching conditions to deter crime and disorder and these may include Conditions drawn from the Model Poll of Conditions relating to Crime and Disorder. **(See Appendix 2 Annex D of the Licensing Policy).**

Police Powers

The Licensing Act 2003, Part 8 gives a senior police officer the power to close a premises for up to 24 hours where the officer believes there is, or is likely to be disorder on or in the vicinity and closure is necessary in the interests of public.

Guidance Issued under Section 182 of the Licensing Act 2003.

The pool of conditions, adopted by the council is recommended (Annexe D).

The key role of the police is acknowledged (2.2).

Conditions attached to licences cannot seek to manage the behaviour of customers once they are beyond the direct management of the licence holder and their staff or agents, but can directly impact on the behaviour of customers on, or in the immediate vicinity of the premises as they seek entry or leave (2.4).

Conditions are best targeted on deterrence and preventing crime and disorder (S.2.6) communication, CCTV, police liaison, no glasses, capacity limits are all relevant (S.2.7-2.11).

Conditions can be imposed for large capacity "vertical consumption" premises (10.43).

There is also guidance issued around the heading of "public nuisance as follows

The pool of conditions, adopted by the council is recommended (Annexe G).

Licence conditions should not duplicate other legislation (1.16).

Necessary and appropriate conditions should normally focus on the most sensitive periods and may address disturbance as customers enter or leave the premises (2.36) but it is essential that conditions are focused on measures within the direct control of the licence holder" (2.38). Conditions relating to behaviour once they are beyond the control of the licence holder cannot be justified. (2.38)

Other Legislation

Crime and Disorder Act 1998

The Council has a duty under Section 17 of the Crime and Disorder Act 1998 to do all it reasonably can to prevent crime and disorder.

The Act also introduced a wide range of measures designed to address anti-social behaviour committed by adults and young people. These include:

- Anti-Social Behaviour Orders
- Child Curfew Schemes
- Truancy
- Parenting Orders
- Reparation Orders
- Tackling Racism

Appendix 13

Section 182 Advice by the DCMS

Public Safety

2.19 Licensing authorities and responsible authorities should note that the public safety objective is concerned with the physical safety of the people using the relevant premises and not with public health, which is dealt with in other legislation. There will of course be occasions when a public safety condition could incidentally benefit health, but it should not be the purpose of the condition as this would be ultra vires the 2003 Act. Accordingly, conditions should not be imposed on a premises licence or club premises certificate which relate to cleanliness or hygiene.

2.20 From 1 October 2006 the Regulatory Reform (Fire Safety) Order 2005 ('the Fire Safety Order') replaced previous fire safety legislation. As such any fire certificate issued under the Fire Precautions Act 1971 will have ceased to have effect. Licensing authorities should note that under article 43 of the Fire Safety Order any conditions imposed by the licensing authority that relate to any requirements or prohibitions that are or could be imposed by the Order automatically cease to have effect, without the need to vary the licence. This means that licensing authorities should not seek to impose fire safety conditions where the Order applies.

2.21 The exception to this will be in cases where the licensing authority and the enforcing authority for the fire safety order are one and the same body. For example, designated sports-grounds and stands where local authorities enforce the fire safety order. In such circumstances fire safety conditions should not be set in new licences, but conditions in existing licences will remain in force and be enforceable by the licensing authority.

2.22 The Fire Safety Order applies in England and Wales. It covers 'general fire precautions' and other fire safety duties which are needed to protect 'relevant persons' in case of fire in and around 'most premises'. The Order requires fire precautions to be put in place 'where necessary' and to the extent that it is reasonable and practicable in the circumstances of the case.

2.23 Responsibility for complying with the Order rests with the 'responsible person', which may be the employer, or any other person or people who may have control of the premises. Each responsible person must carry out a fire risk assessment which must focus on the safety in case of fire for all 'relevant persons'. The fire risk assessment is intended to identify risks that can be removed or reduced and to decide the nature and extent of the general fire precautions that need to be taken including, where necessary, capacity limits.

2.24 The local fire and rescue authority will enforce the Order in most premises and have the power to inspect the premises to check the responsible person is complying with their duties under the Order. They will look for evidence that the responsible person has carried out a suitable fire risk assessment and acted upon the significant findings of that assessment. If the enforcing authority is dissatisfied with the outcome of a fire risk assessment or the action taken, they may issue an enforcement notice that requires the responsible person to make certain improvements or, in extreme cases, issue a prohibition notice that restricts the use of all or part of the premises until improvements are made.

2.25 Further information and guidance about the Order and fire safety legislation is available from the Communities and Local Government website www.communities.gov.uk/fire.

2.26 Where there is a requirement in other legislation for premises open to the public or for employers to possess certificates attesting to the safety or satisfactory nature of certain equipment or fixtures on the premises, it would be unnecessary for a licensing condition to require possession of such a certificate. However, it would be permissible to require as a condition of a licence or certificate, if necessary, checks on this equipment to be conducted at specified intervals and for evidence of these checks to be retained by the premises licence holder or club provided this does not duplicate or gold-plate a requirement in other legislation. Similarly, it would be permissible for licensing authorities, if they receive relevant representations from responsible authorities or interested parties, to attach conditions which require equipment of particular standards to be maintained on the premises. Responsible authorities – such as health and safety authorities – should therefore make clear their expectations in this respects to enable prospective licence holders or clubs to prepare effective operating schedules and club operating schedules.

2.27 "Safe capacities" should only be imposed where necessary for the promotion of public safety or the prevention of disorder on the relevant premises. For example, if a capacity has been imposed through other legislation, it would be unnecessary to reproduce it in a premises licence. Indeed, it would also be wrong to lay down conditions which conflict with other legal requirements. However, if no safe capacity has been imposed through other legislation, a responsible authority may

consider it necessary for a new capacity to be attached to the premises which would apply at any material time when the licensable activities are taking place and make representations to that effect. For example, in certain circumstances, capacity limits may be necessary in preventing disorder, as overcrowded venues can increase the risks of crowds becoming frustrated and hostile.

2.28 As noted above, a capacity limit should not be imposed as a condition of the licence on fire safety grounds (unless the licensing authority and the enforcing authority for fire safety purposes are the same) since, under article 43 of the Fire Safety Order, it would have no effect and so would not be enforceable.

2.29 The special provisions made for dancing, amplified and unamplified music in section 177 of the 2003 Act apply only to premises with a "permitted capacity" of not more than 200 persons. In this context, the capacity must be where the fire and rescue authority has made a recommendation on the capacity of the premises under the Fire Safety Order. For any application for a premises licence or club premises certificate for premises without an existing permitted capacity where the applicant wishes to take advantage of the special provisions set out in section 177 of the 2003 Act, the applicant should conduct their own risk assessment as to the appropriate capacity of the premises. They should send their recommendation to the fire and rescue authority who will consider it and then decide what the "permitted capacity" of those premises should be.

2.30 Whilst the Cinematograph (Safety) Regulations 1955 (S.I 1995/1129) which contained a significant number of regulations in respect of fire safety provision at cinemas, no longer apply, applicants taking advantage of the "grandfather rights" pursuant to Schedule 8 to the 2003 Act will have been subject to conditions which re-state those regulations in their new premises licence or club premises certificate. Any holders of a converted licence seeking to remove these conditions and reduce the regulatory burden on them (to the extent to which that can be done while still promoting the licensing objectives), would need to apply to vary their converted licences or certificates. When considering variation applications or applications for new licences, licensing authorities and responsible authorities should recognise the need for steps to be taken to assure public safety at these premises in the absence of the 1995 Regulations.

2.31 Public safety includes the safety of performers appearing at any premises.

Appendix 14

Planning

An application for a Premises Licence can be made in respect of a premises even where the premises does not have relevant Planning Permission. That application has to be considered and Members can only refuse the application where the application itself does not promote one or more of the Licensing Objectives. Members cannot refuse just because there is no planning permission. Where a Premises Licence is granted and which exceeds what is allowed by the Planning Permission and that Premises then operates in breach of planning then the operator would be liable to enforcement by Planning.

Appendix 15

Licensing Policy relating to hours of trading

All applications have to be considered on their own merits.

The Council has however adopted a set of framework hours as follows

Sunday to Thursday 06 00 hrs to 23 30 hrs

Friday and Saturday 06 00 hrs to midnight

(see 12.8 Of the licensing policy)

In considering the applicability of frame work hours to any particular application regard should be had to the following

- Location
- Proposed hours of regulated activities, and the proposed hours the premises are open to the public
- The adequacy of the applicants proposals to deal with issues of crime and disorder and public nuisance
- Previous history
- Access to public transport
- Proximity to other licensed premises, and their hours

(see 12.8 of the licensing policy)

Subject to any representations to the contrary in individual cases the following premises are not generally considered to contribute to late night anti-social behaviour and will therefore generally have greater freedom

- Theatres
- Cinemas
- Premises with club premises certificates
- Premises licensed for off sales only